

# SPECIFICATION CONTROL DRAWING

THIS DRAWING CONTAINS INFORMATION PROPRIETARY TO RF INDUSTRIES, LTD. ANY UNAUTHORIZED USE OF THIS DRAWING IS EXPRESSLY PROHIBITED. ANY VIOLATION IS PUNISHABLE UNDER U.S. COPYRIGHT LAWS.

REV	DESCRIPTION	DWN	DATE	APPROVED
A	ENGINEERING RELEASE	KMM	9/1/93	K.HARTMANN
B	CHANGE PART NUMBER FROM RSA-2313 TO RSA-3300	WMD	2/20/93	C. JONES
C	CORRECT BODY LENGTH DIM	KMM	9/7/96	R. RICE

008974

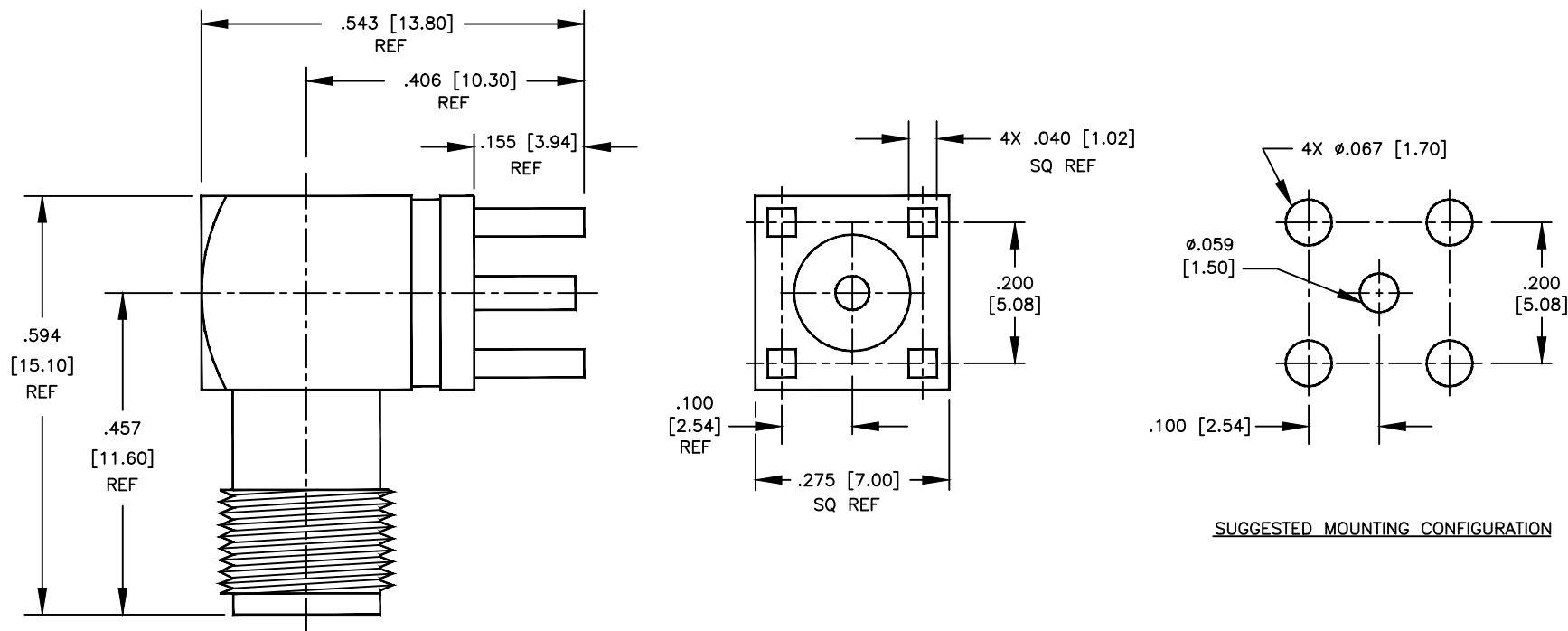

## SPECIFICATIONS:

IMPEDANCE: 50 OHMS

ITEM	DESCRIPTION	QTY	MATERIAL	FINISH
5	DIELECTRIC	1	PTFE	NONE
4	DIELECTRIC	1	PTFE	NONE
3	CONTACT	1	BeCu	GOLD
2	PRESS FIT BODY	1	BRASS	GOLD
1	BODY	1	BRASS	GOLD

DIMENSIONS ARE IN INCHES AND [MILLIMETERS]

UNLESS OTHERWISE NOTED TOLERANCES ARE:

DECIMALS      DIAMETER

DRAWN	K. MAXWELL	9/7/96
CHECKED		
ORJ DRAWN	K. MAXWELL	9/1/93
APPROVALS		DATE

**RFconnectors**  
DIVISION OF RF INDUSTRIES, LTD.

7610 MIRAMAR RD  
SAN DIEGO, CA 92126  
(619)549-6340  
(619)549-6345 FAX

RSA-3300-1

SMA FEMALE R/A PCB MOUNT

SIZE	CABLE GROUP	DWG NO.	REV
A	N/A	8201	C
SCALE:	4:1	CAD FILE	13ARC B
			SHEET 1 OF 1